

## La Joya Perla - Phase 1 residential complex

Location **Iskele, Bahçeler**



### About the project



Developer	<b>DND Homes</b>
Start of sale	<b>01.09.2023</b>
Key handover	<b>2026</b>
Houses/blocks	<b>9</b>
Building floor	<b>2</b> Min <b>2</b> Max
Units total	<b>204 - Studio, 156 - 1+1, 24 - 2+1</b>

Distance to the sea - 700 m  
 Distance to key locations:  
 School - 1.5 km. Ercan Airport - 49 km. Beach club - 700 m.  
 Shopping center - 2.5 km. Famagusta - 22 km. Hospital - 3 km.

La Joya Perla is an exclusive luxury residential project located in Bahçeler/Iskele, offering a unique blend of elegance, comfort, and extraordinary design.

### Complex infrastructure

- Aqua park ✔
- Bar ✔
- Beauty salon ✔
- Fitness centr. ✔
- Indoor pool ✔
- Kid's play room ✔
- Kid's playground ✔
- Open pool ✔
- Parking ✔
- Restaurant ✔

### Available units **14** / 384 total

#### Median price per unit, K GBP

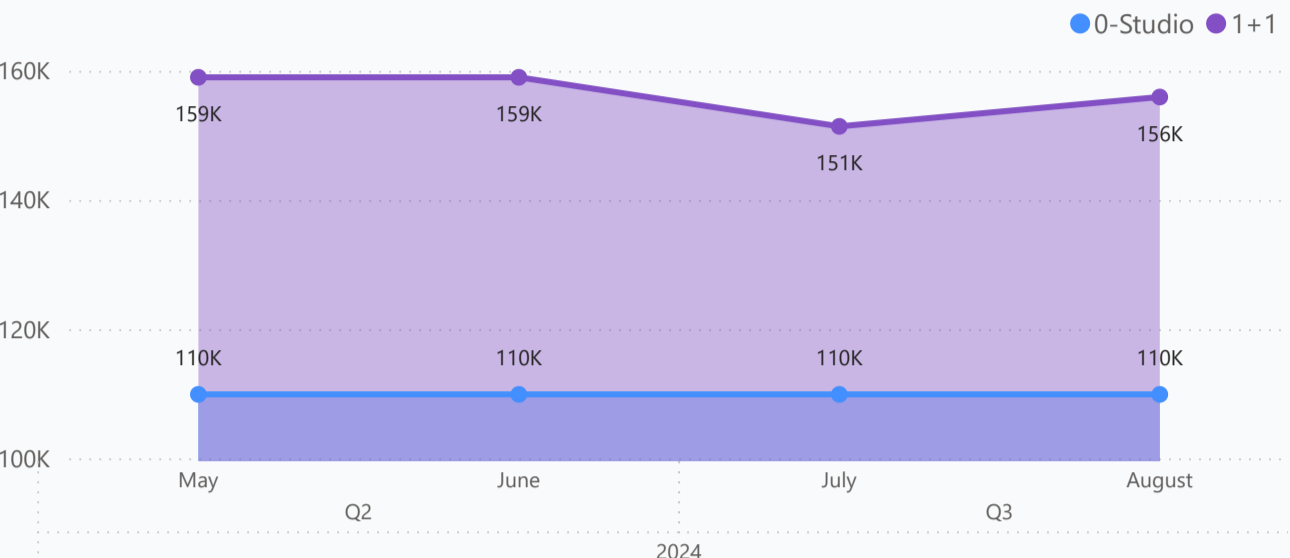

#### Structure of available units

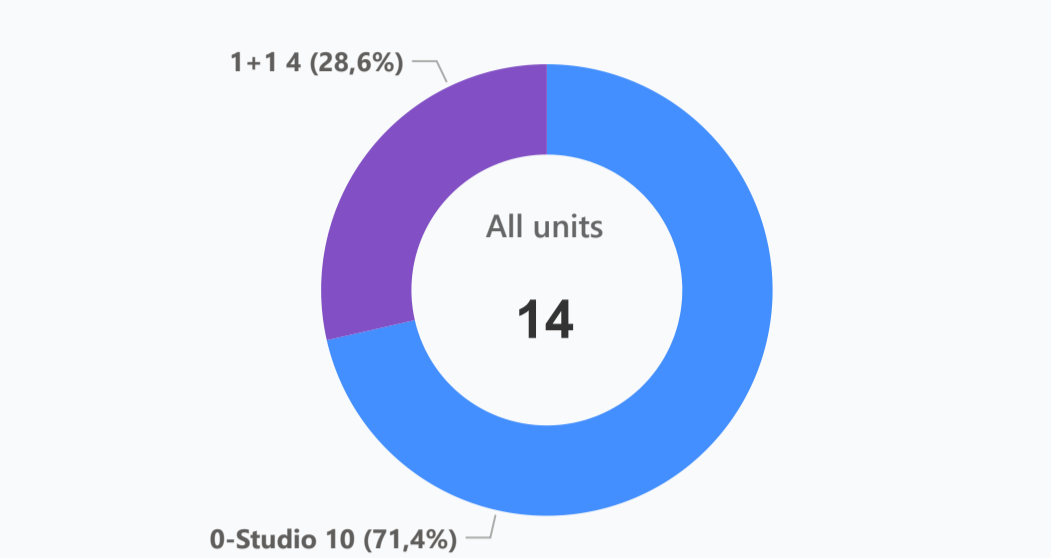

### Plans



0-Studio



1+1

### Payment plans

Deposit (non-refundable) 5 %

Option	Down payment	Installments months	Discount	Offer
Option 1	35 %	45% till key, 20%...	-	-
Option 2	50 %	30% till key, 20%...	-	-
Option 3	45 %	55% till key + 30%...	-	No payment up to 6 months ...
Option 4	-	-	-	-

### Special offer

Fully furnished design package

Rental guarantee

Trafo 1500 GBP Resale - Maintenance fee 60-120 GBP Rental services -

### Details

Bedrooms	Subtype	Block	Unit №	Floor	View	Bathroom	Internal area, sq. m	Balcony/Terrace, sq. m	Rooftop terrace, sq. m	Garden, sq. m	Gross covered area, sq. m	Current price, GBP	Price per sqm, GBP
0-Studio	Flat	C	32	0		1	30	4		6	46	99 900	2 172
0-Studio	Flat	D	22	0		1	36	4		6	51	109 900	2 155
0-Studio	Flat	D	27	0		1	36	4		6	51	109 900	2 155
0-Studio	Flat	D	33	0		1	36	4		6	51	109 900	2 155
0-Studio	Flat	E	23	0		1	30	4		6	46	109 900	2 389
0-Studio	Flat	E	24	0		1	30	4		6	46	109 900	2 389
0-Studio	Flat	E	21	0		1	36	4		6	51	119 900	2 351
0-Studio	Flat	E	22	0		1	36	4		6	51	119 900	2 351
0-Studio	Flat	F	13	0		1	30	4		6	46	109 900	2 389
0-Studio	Flat	F	9	0		1	36	4		6	51	119 900	2 351
1+1	Flat	A	20	01		1	46	4	25		82	159 000	1 939
1+1	Flat	B	32	01		1	46	4	25		82	152 900	1 865
1+1	Flat	D	47	01		1	41	3	23		74	149 900	2 026
1+1	Flat	F	27	01		1	46	4	25		82	159 000	1 939

### Interior specification



- Ceramic flooring ✔
- Double glazed windows ✔
- Steel ladder with wood step ✔
- Toilet integrated in the walls ✔

### Exterior specification

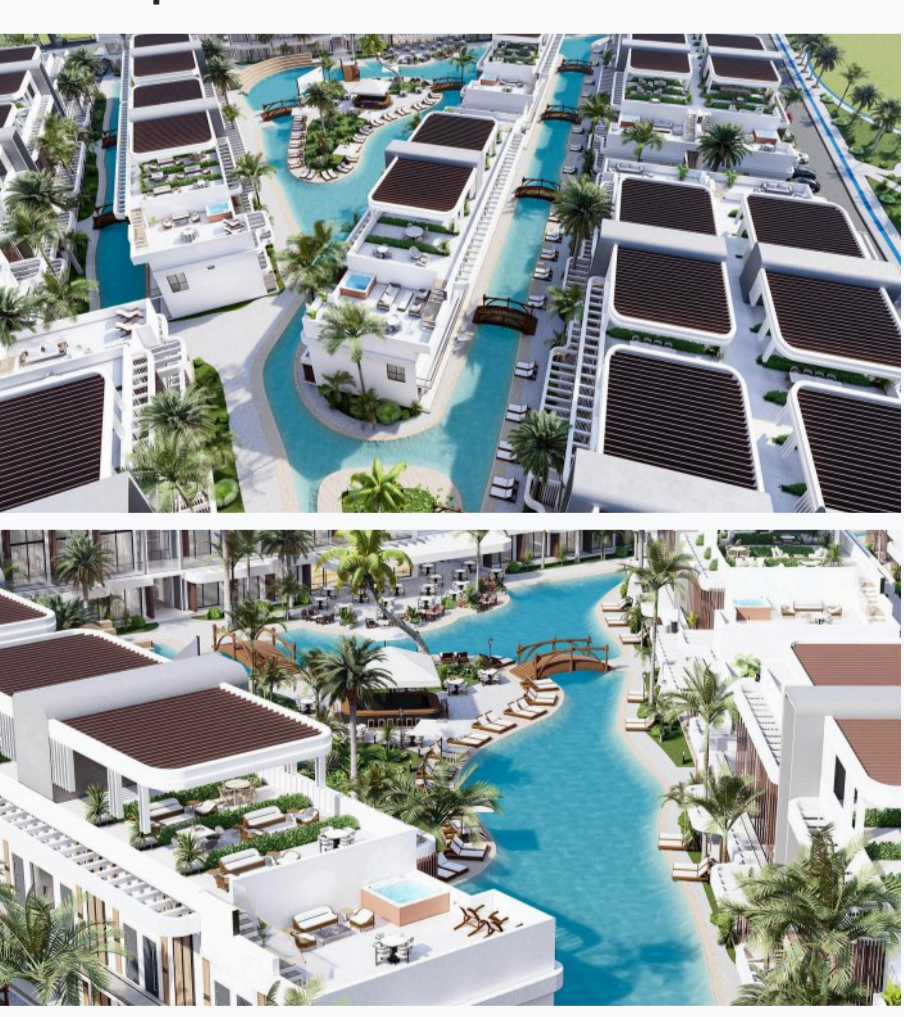

- Jacuzzi ✔
- Terracing with inbuilt lighting & power sockets ✔

### Location of complex

